



Joppatowne High School Limited Renovation Schematic Design

*Presentation to the
Board of Education
August 12, 2019*



Background

- County Wide Facility Assessment
- Multiple critical systemic problems
 - Major HVAC
 - Building envelope
 - Structural
 - ADA deficiencies
 - Safety and security issues

Addressing the systemic needs

- Scope study was approved by the BOE December 2009
- Systemic renovation put forward to the State
- State would not fund multiple systemic renovations and recommended the project be put forward as a limited renovation



Scope of Systemic Renovations

Structural

- Settlement issues
- Auditorium Brick Veneer

Mechanical

- HVAC

Plumbing

- Domestic Water Service
- Toilet Rooms

Electrical

- Code Upgrades

Safety and Security

- Fire Sprinkler
- Security vestibule

Other

- ADA compliancy
- Exterior doors
- Floor finishes
- Lockers
- Windows
- Ceilings
- Stadium Upgrades
- Resurface parking lot



Scope of Educational Program Improvements

- Homeland Security Signature Program
- Child Development Laboratory
- Professional Foods Laboratory
- Graphic Laboratory
- Science Laboratories
- Harford Community College Early College Program
- Special Education Life Skills Classroom



Educational Specification to Schematic

- March 11, 2019 – June 12, 2019 Kick-off meeting to Ed Spec Draft Committee
- June 17, 2019 – BOE Approves Educational Specification
- July 1, 2019 - Maryland State Department of Education
- August 12, 2019 - BOE Meeting to Review Schematic Design Board Approves Construction Manager
- August 30, 2019 - Schematic Design to IAC
- October 31, 2019 - Design Development to IAC
- March 20, 2020 – 95% Construction Documents to IAC
- April 14, 2020 – Construction Bidding and Building Permit Process
- July 1, 2020 – Construction Begins



Space Summary

Limited Renovation Summary	No. Of Spaces	Size Subtotal	No. Teach Station
Total area of major renovation: demolition, new wall & ceiling construction, finishes, Etc.	82	35,325	18
Total spaces to receive minor upgrades and systemic	77	86,229	35
TOTAL NET PROGRAM	159	121,554	53
TOTAL GROSS SQ.FT.		184,070	

Part Site Plan South

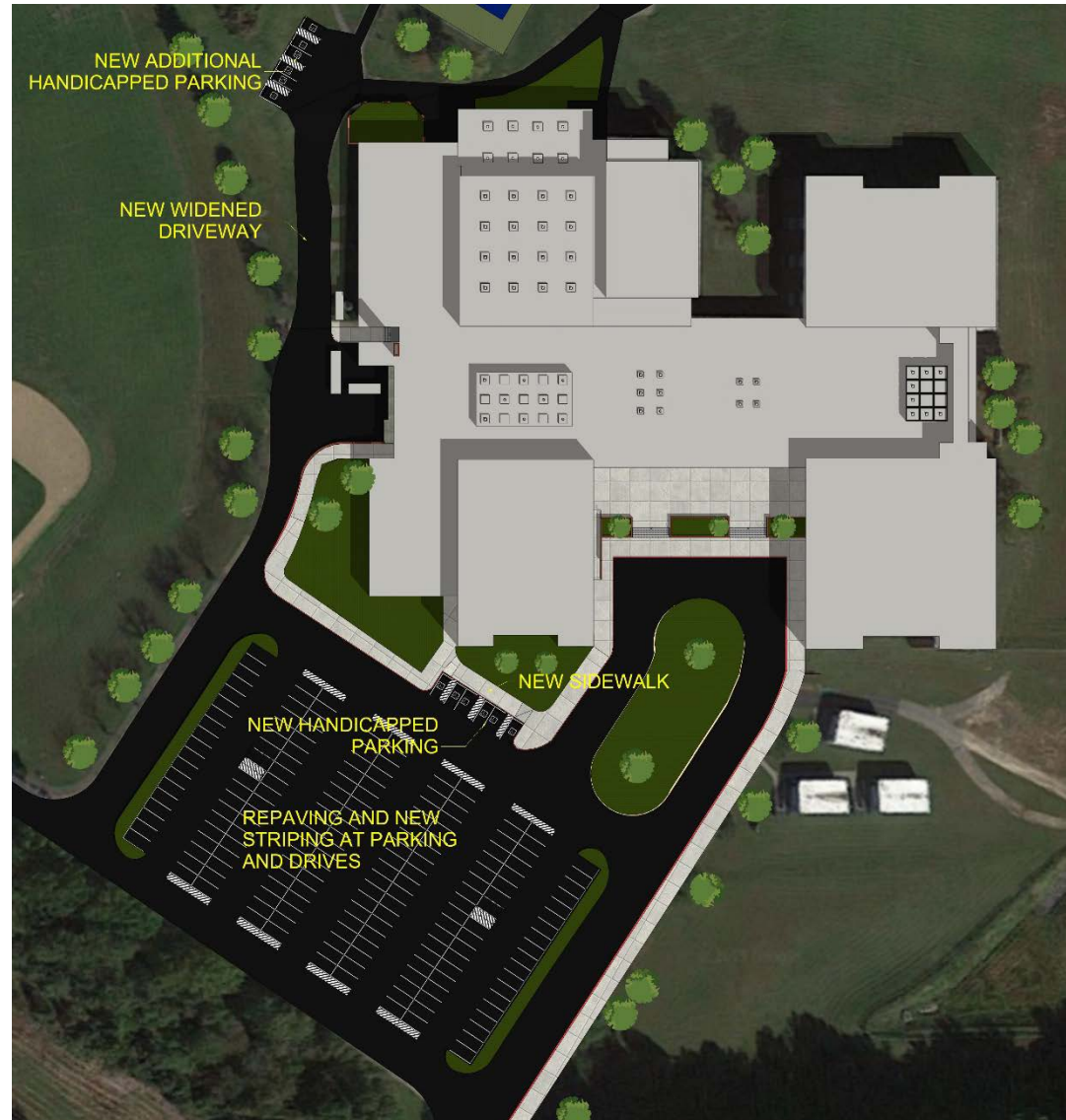

Part Site Plan North





Main Level Plan



- MAJOR RENOVATION:**
DEMOLITION, NEW WALL AND CEILING CONSTRUCTION, ETC.
43,852 S.F. IN TOTAL FACILITY
- MODERATE RENOVATION:**
PRIMARILY CEILING AND FLOOR FINISH REPLACEMENTS, SYSTEMIC RENOVATION
82,193 S.F. IN TOTAL FACILITY
- MINOR RENOVATION:**
PRIMARILY EFFECTS OF SYSTEMIC RENOVATION, WINDOW REPLACEMENT, DOOR REPLACEMENT, SPRINKLER, FIRE ALARM, ETC., MISC. PATCH AND REPAIR
58,049 S.F. IN TOTAL FACILITY
- MINOR ADDITION AREA:**
NEW ELECTRIC SERVICE ROOM - 460 S.F.
ENTRY VESTIBULE - 30 SF
490 S.F. IN TOTAL FACILITY



Lower Level Plan

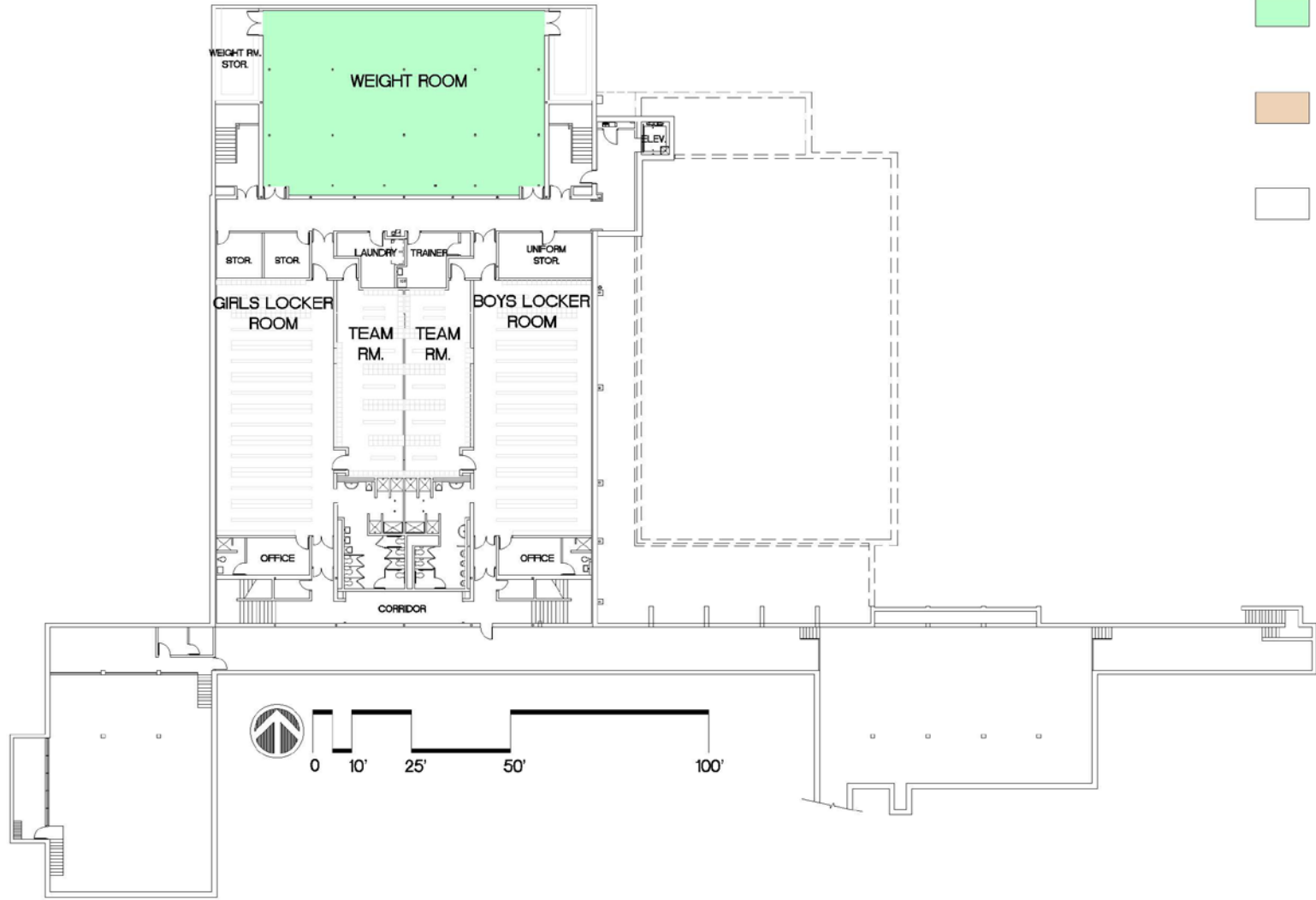

- MAJOR RENOVATION:**
DEMOLITION, NEW WALL AND CEILING CONSTRUCTION, ETC.
3,350 S.F. THIS LEVEL
41,645 S.F. IN TOTAL FACILITY
- MODERATE RENOVATION:**
PRIMARILY CEILING AND FLOOR FINISH REPLACEMENTS, SYSTEMIC RENOVATION
84,400 S.F. IN TOTAL FACILITY
- MINOR RENOVATION:**
PRIMARILY EFFECTS OF SYSTEMIC RENOVATION, WINDOW REPLACEMENT, DOOR REPLACEMENT, SPRINKLER, FIRE ALARM, ETC., MISC. PATCH AND REPAIR
58,049 S.F. IN TOTAL FACILITY



Upper Level Plan



- MAJOR RENOVATION:**
 DEMOLITION, NEW WALL AND CEILING CONSTRUCTION, ETC.
 5,742 S.F. THIS LEVEL
 43,852 S.F. IN TOTAL FACILITY
- MODERATE RENOVATION:**
 PRIMARILY CEILING AND FLOOR FINISH REPLACEMENTS
 25,518 S.F. THIS LEVEL
 82,193 S.F. IN TOTAL FACILITY
- MINOR RENOVATION:**
 PRIMARILY EFFECTS OF SYSTEMIC RENOVATION, WINDOW REPLACEMENT, DOOR REPLACEMENT, SPRINKLER, FIRE ALARM, ETC., MISC. PATCH AND REPAIR
 58,049 S.F. IN TOTAL FACILITY

Auditorium South



Auditorium Southeast





Window Replacement





Interior Lobby – Entry Vestibule





Interior – “Main Street Corridor”





Field Buildings



Concessions and Bathrooms



Team Rooms and Storage



Questions and Discussion

The Superintendent of Schools recommends that the Board of Education approve the Schematic Design for the Joppatowne High School Limited Renovation for submission to the State.