

GENERAL PLAN NOTES

- DO NOT LEAVE DEBRIS, TRASH, TOOLS OR MATERIALS ALONG THE BUILDING EXTERIOR OVERNIGHT. DO NOT STORE TOOLS OR MATERIALS AT JOBSITE OUTSIDE OF PROJECT AREA.
- CLEAN WORK AREA AND DISPOSE OF ANY TRASH OR BULK DEBRIS AT THE END OF EACH WORK DAY.
- PROVIDE AND LOCATE FIRE EXTINGUISHERS PER FIRE MARSHAL'S DIRECTIONS.
- PAINT - PRIME PLUS 2 COATS.
- ALL OUTLET COVERS AND SWITCHPLATES SHALL BE BRUSHED STAINLESS STEEL.
- WB DESIGNATES 4" TALL WHITE MARKER BOARD, LENGTH INDICATED.
- 10 DESIGNATES 4" TALL TACK BOARD, LENGTH INDICATED.
- 10 DESIGNATES INTERACTIVE FLAT SCREEN MONITOR, DIAGONAL SIZE INDICATED - FURNISHED AND INSTALLED BY OWNER. MOUNTING BRACKETS AND ASSOCIATED HARDWARE FURNISHED AND INSTALLED BY OWNER.

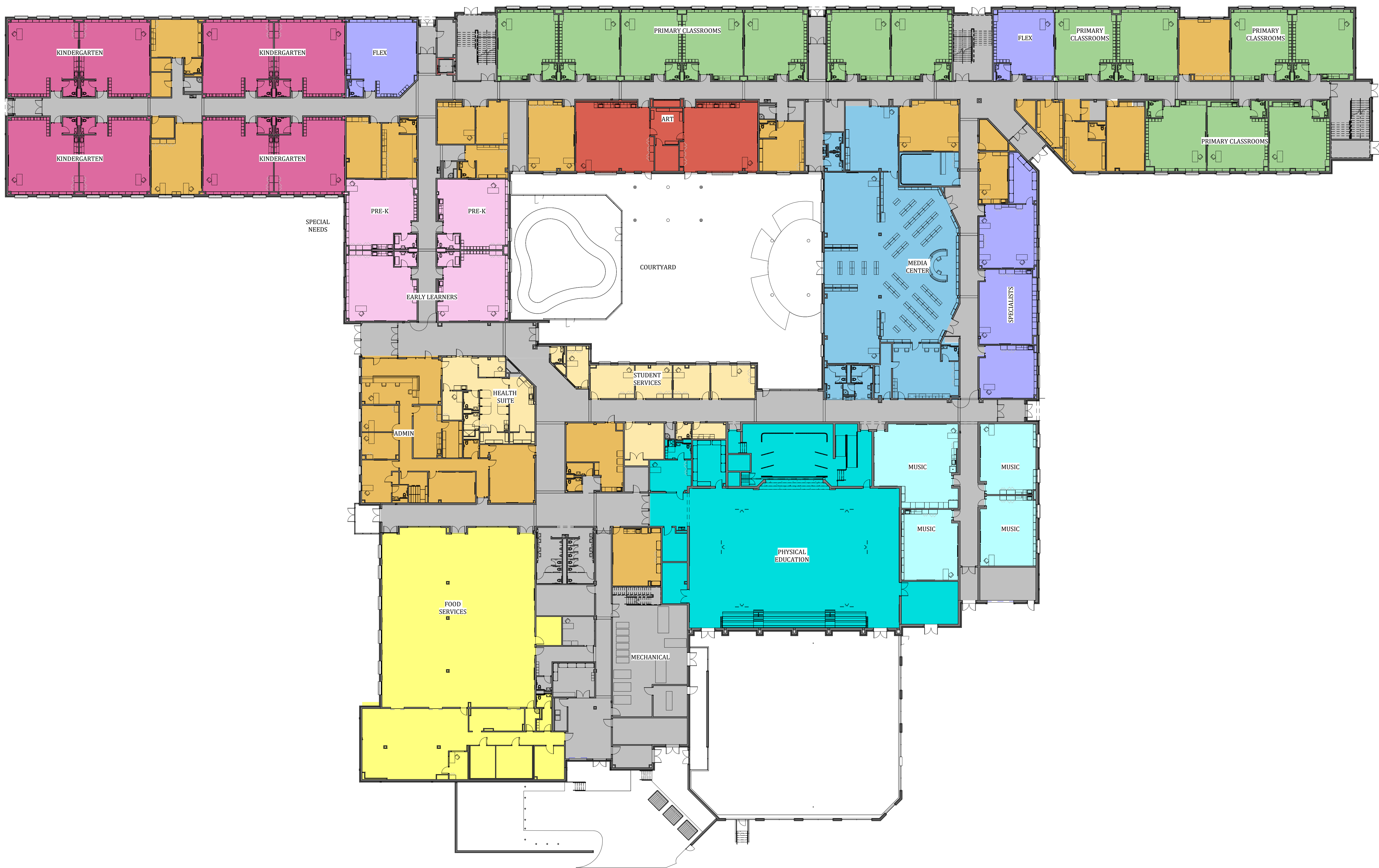

2 SECOND FLOOR - OVERALL  
3/64" = 1'-0"



1 FIRST FLOOR - OVERALL  
3/64" = 1'-0"

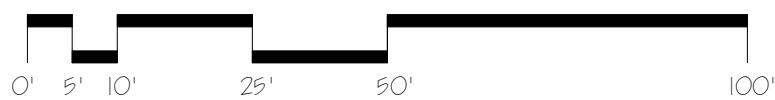

- PRE-K / EARLY LEARNERS CLASSROOMS
- KINDERGARTEN CLASSROOMS
- PRIMARY CLASSROOMS
- INTERMEDIATE CLASSROOMS
- ART
- MUSIC
- PHYSICAL EDUCATION
- SPECIALIST AREAS
- MEDIA CENTER
- FOOD SERVICES
- ADMINISTRATION / TEACHER PLANNING
- HEALTH SUITE / STUDENT SERVICES
- CORRIDOR / RESTROOM / MECHANICAL

COLOR LEGEND

ISSUE or REVISION		
NO.	DESCRIPTION	DATE
	CONSTRUCTION DOCUMENTS	02/04/2022
	BID RELEASE	03/18/2022



PSC NO. 12.022.22 LP

HOMESTEAD WAKEFIELD ELEMENTARY  
SCHOOL REPLACEMENT

900 SOUTH MAIN STREET, BEL AIR, MARYLAND  
21014



OWNER/DEVELOPER:

HARFORD COUNTY  
PUBLIC SCHOOLS

102 SOUTH HICKORY AVENUE  
BEL AIR, MARYLAND 21018

SHEET TITLE:

FLOOR PLANS BY PROGRAM  
AREA

Professional Certification

I certify that these documents were prepared or approved by me, and that  
I am a duly licensed architect under the laws of the State of Maryland.  
License No. 69023-A Expiration Date: 01-22-2024

BCA  
Banta Campbell  
ARCHITECTS, INC.

10221 Wincopin Circle, Suite 210  
Columbia, Maryland 21044  
410.290.9009  
www.bantacampbell.com

DATE: 09/18/2022

PROJECT No:

BCA:

21-580

A-100